



GCE AS/A level

1202/01

GEOGRAPHY G2

CHANGING HUMAN ENVIRONMENTS

P.M. FRIDAY, 22 January 2010

1½ hours

1
W10 1202 01

ADDITIONAL MATERIALS

In addition to this examination paper you will need **one** 12 page answer booklet.

INSTRUCTIONS TO CANDIDATES

Answer **all** questions.

Write your answers in the separate answer book provided.

Write your name, centre number and candidate number in the spaces at the top of the answer book.

INFORMATION FOR CANDIDATES

Each question carries **25** marks.

The number of marks is given in brackets at the end of each question or part-question.

You are reminded of the need for good English and orderly, clear presentation in your answers. Assessment will take into account the quality of written communication used in your answers.

THIS PAPER REQUIRES THAT YOU MAKE THE FULLEST POSSIBLE USE OF APPROPRIATE EXAMPLES IN SUPPORT OF YOUR ANSWERS. SKETCH-MAPS AND DIAGRAMS SHOULD BE INCLUDED WHERE RELEVANT.

G2 - CHANGING HUMAN ENVIRONMENTS

Answer **all** questions

Make the fullest possible use of examples in support of your answers.

Figure 1: Estimated Deaths From AIDS During 2006

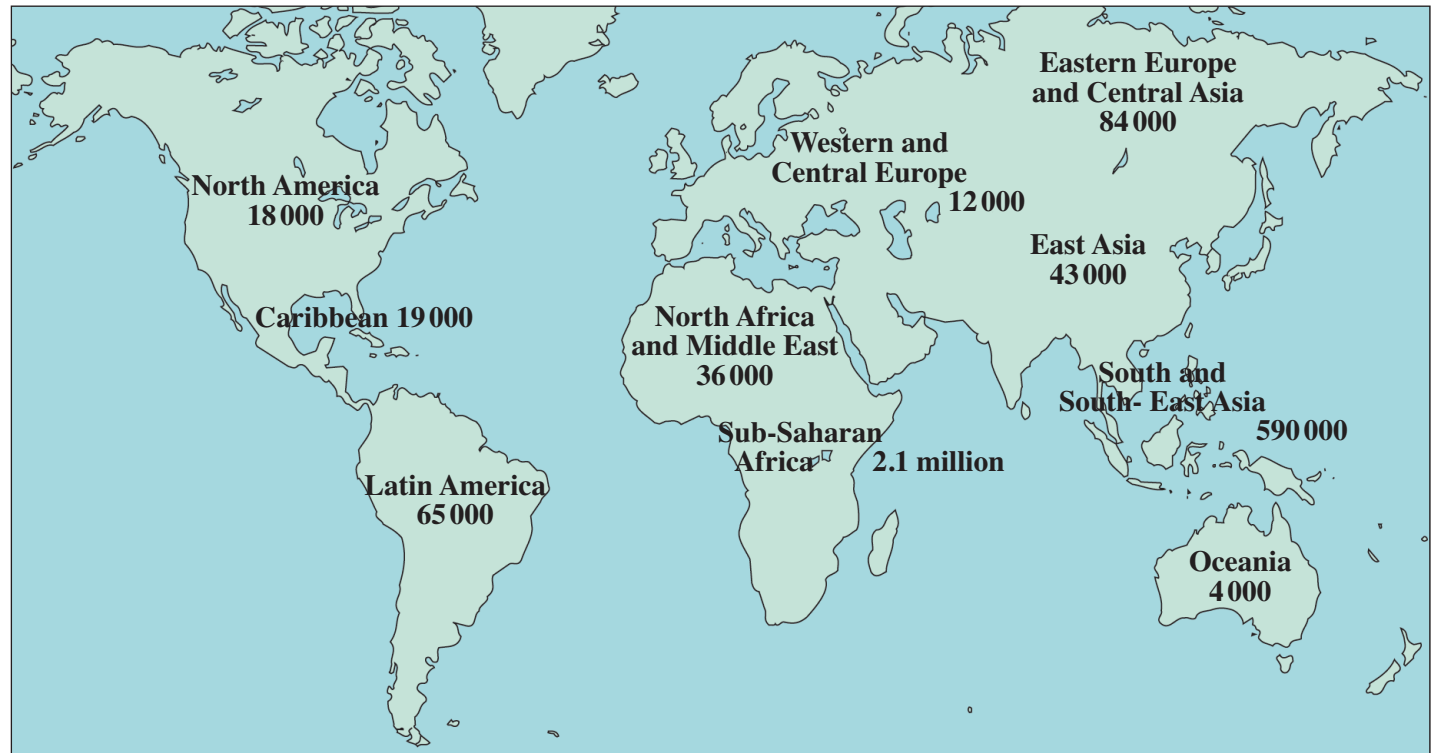

Total: 2.9 million





1. (a) Use information from **Figure 1** to describe the distribution of estimated deaths from AIDS. [5]

- (b) Outline **two** impacts of out-migration on a country or region that exports its population. [10]

- (c) Explain how and why population changes naturally over time. [10]

Figure 2: A Regenerated Area of Oslo, Norway



Photograph: Principal Examiner

2. (a) Use **Figure 2** to suggest how this area has been regenerated. [5]
- (b) Outline how migrations within an urban area may result in different groups of people living in different areas. [10]
- (c) Outline why rural settlements are changing. [10]

Figure 3: Plan of the Shopping Centre in the CBD of Skelmersdale

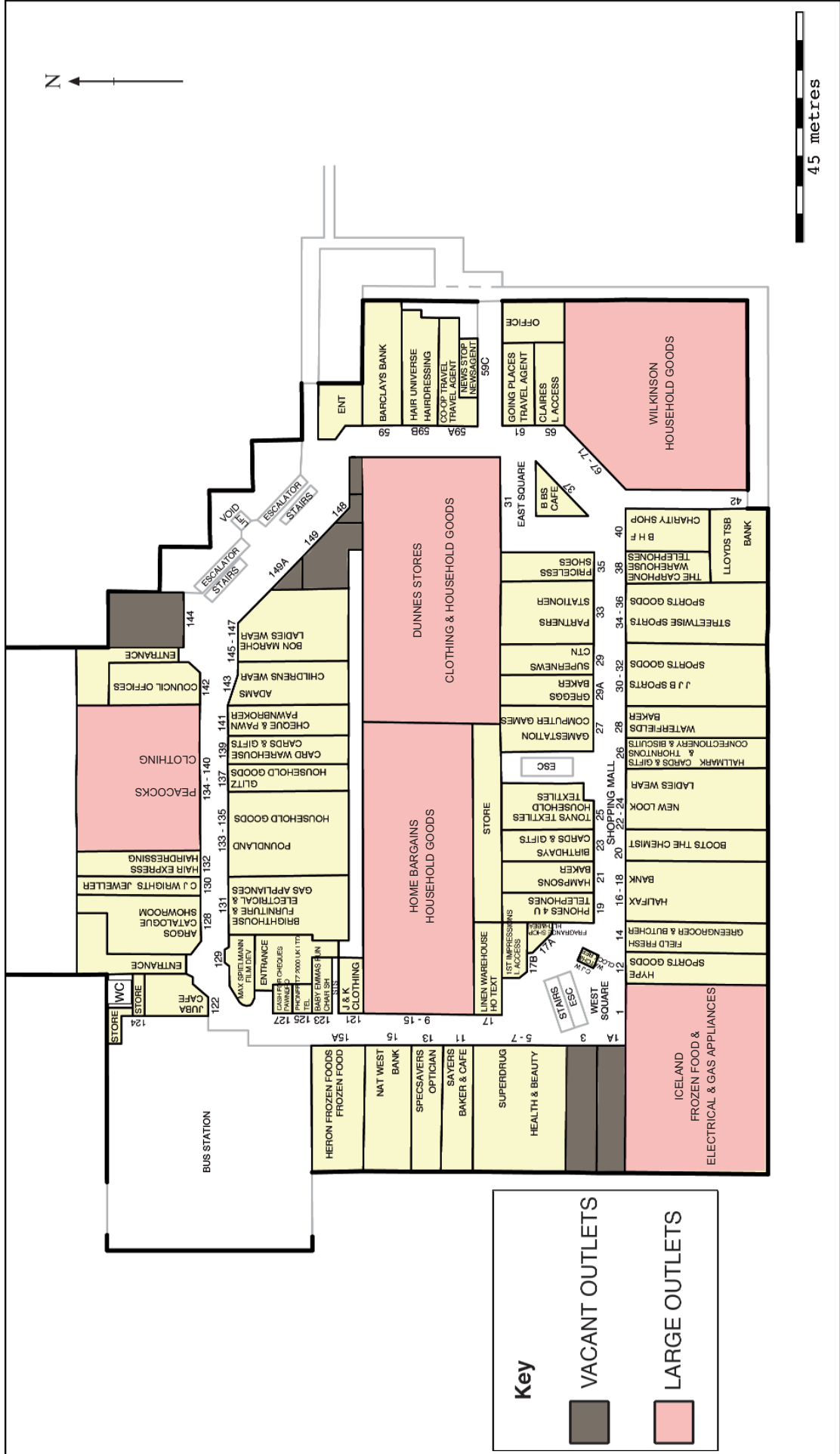

3. **Figure 3** shows the start of an investigation into retailing in Skelmersdale town centre.
- (a) Use **Figure 3** to describe the distribution of vacant outlets and large retail outlets. [7]
 - (b) Describe and justify **two** other methods of obtaining data to investigate retailing in the town centre shown in **Figure 3**. [8]
 - (c) Outline the limitations in your own investigation into a changing human environment and how they may be overcome. [10]
You should state clearly the question that you have investigated.